

CORRECTED  
 JAN 8 1940  
 OCT 23 1941  
 NOV 12 1942  
 DEC 19 1943  
 JAN 23 1944  
 FEB 15 1945  
 NOV 25 1946  
 JUL 30 1970  
 JUL 4 1970  
 JUL 15 1971  
 OCT 7 1971  
 1972  
 1975  
 APR 26 1982  
 JAN 24 1983  
 FEB 23 1983  
 DEC 11 1984  
 FEB 1 1986

Dwg. No.: 2963  
 Source: Tax Maps Bureau  
 BY: H.N. & S.L.C. Sept. 1936.

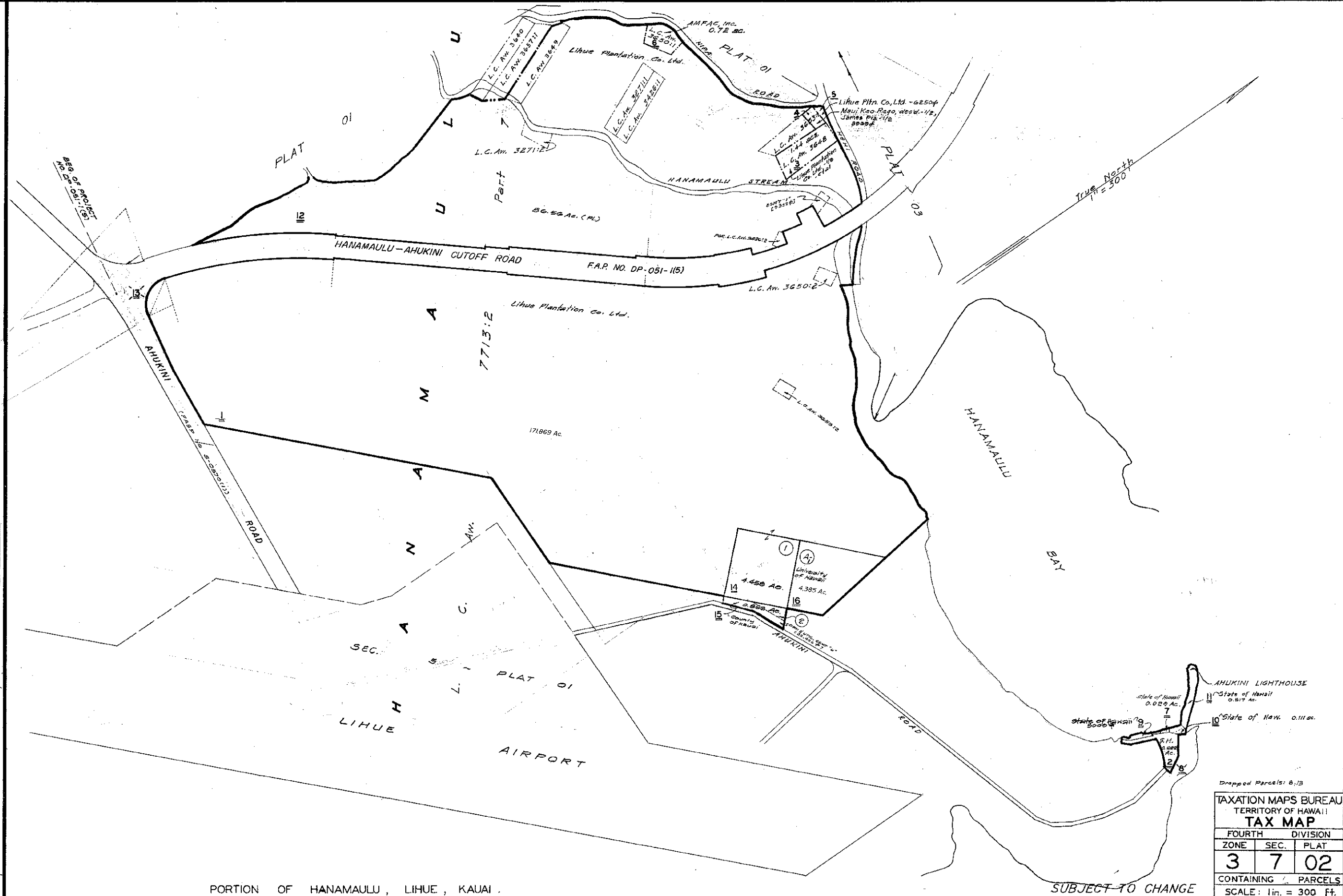

PORTION OF HANAMAULU, LIHUE, KAUAI.

SUBJECT TO CHANGE

Dropped Parcels: 8/13

TAXATION MAPS BUREAU		
TERRITORY OF HAWAII		
TAX MAP		
FOURTH	DIVISION	
ZONE	SEC.	PLAT
3	7	02
CONTAINING PARCELS		
SCALE: 1 in. = 300 Ft.		

PRINTED